

**AIA**[®]**Document G701[®] – 2017****Change Order****PROJECT:** *(Name and address)*Softball Complex Sulphur Springs Park
Madison County, Mississippi**CONTRACT INFORMATION:**Contract For: General Construction
Date: 06 May 2024**CHANGE ORDER INFORMATION:**Change Order Number: 004
Date: 18 August 2025**OWNER:** *(Name and address)*Madison County Board of Supervisors
146 W. Center St., Canton, MS**ARCHITECT:** *(Name and address)*JH&H Architects Planners Interiors PA
1047 N. Flowood Dr., Flowood, MS**CONTRACTOR:** *(Name and address)*England Enterprises, Inc.
8295 Wildwood Rd., Vaughan, MS**THE CONTRACT IS CHANGED AS FOLLOWS:***(Insert a detailed description of the change and, if applicable, attach or reference specific exhibits. Also include agreed upon adjustments attributable to executed Construction Change Directives.)*

Addition of sod and irrigation to playfield: \$77,851.52

Addition of sod and irrigation to slopes between the site and lake: \$86,680.28

Total Change Order (to be added to the Contract Sum): \$164,531.80

The original Contract Sum was	\$ 1,822,000.00
The net change by previously authorized Change Orders	\$ 233,525.86
The Contract Sum prior to this Change Order was	\$ 2,055,525.86
The Contract Sum will be increased by this Change Order in the amount of	\$ 164,531.80
The new Contract Sum including this Change Order will be	\$ 2,220,057.66

The Contract Time will be increased by thirty-nine (39) days.

The new date of Substantial Completion will be 07 August 2025

NOTE: This Change Order does not include adjustments to the Contract Sum or Guaranteed Maximum Price, or the Contract Time, that have been authorized by Construction Change Directive until the cost and time have been agreed upon by both the Owner and Contractor, in which case a Change Order is executed to supersede the Construction Change Directive.

NOT VALID UNTIL SIGNED BY THE ARCHITECT, CONTRACTOR AND OWNER.

JH&H Architects Planners Interiors PA

ARCHITECT *(Firm name)*

England Enterprises, Inc.

CONTRACTOR *(Firm name)*

Madison County Board of Supervisors

OWNER *(Firm name)***SIGNATURE**

Joshua Jeffcoat, Architect

SIGNATURE

David England, President or Leana England, Treasurer

SIGNATURE

Gerald Steen, Board President

PRINTED NAME AND TITLE**DATE****PRINTED NAME AND TITLE****DATE****PRINTED NAME AND TITLE****DATE**

England Enterprises, Inc.

General Contractors

8295 Wildwood Road
Vaughan, MS 39179
601.906.0218
englandenterprisesinc@gmail.com

August 6, 2025

Mr. Josh Jeffcoat
JH&H Architects
1047 North Flowood Drive
Flowood, MS 39232-9533

Re: 21-027B Softball Complex, Sulphur Springs Park
Proposed Change Request 14: additional sod and irrigation prices

Josh,

The cost to add additional sod and extend the irrigation system to cover the slope and play areas that were originally contracted to be seeded, will be total of **\$164,531.80**. The Playfield Sod & Irrigation cost is **\$77,851.52** and the Slope area Sod & Irrigation cost is **\$86,680.28**. The County may select either or both options. As the County has no contingency funds remaining, profit and overhead of 10% has been added to the cost of this work and is included in the total above.

A copy of the irrigation proposal and a drawing indicated the locations of the additional sod are included for your review. Once approved, we expect it will take approx. four weeks to complete this work. If you have any questions, please give me a call.

Thanks,



David England

Attachments
Wilson & Wilson proposal
Sod locations drawing



Quotation

2610 Lakeland Dr.
Jackson, MS 39232
ph: 601-939-8810 fax: 601-939-8933

taylor@wilsonandwilsonirrigation.com
www.wilsonandwilsonirrigation.com

DATE: 8/5/2025
Drawing # RFC 2
MS License # 07988-SC
AL License # S-47840
FL License #'s SP5000, I-166,
FL License #'s C-083-IR,
LA License # 13-0568

Quotation For:**Project:**

	Sulphur Springs Park
	Softball Complex
	Madison, MS

Plan DatedPages**Fax:****Phone:**

We can begin work approximately **5-7** days from acceptance of proposal

Quotation valid for: 30 days

QUANTITY	DESCRIPTION	AMOUNT
	RFC #2	
	<u>Add Coverage Per Site Walk w/ David England</u>	
131	New Rotors @ New Sod Areas	
7	New Zone Valves	
1	Control Panel/Module Upgrade	
As Needed	New Wiring from New Valve Locations Back to Controller	
	Area #1 Price	13,565.00
	Area #2 Price	14,900.00
	Total For RFC #2	28,465.00
	<p><i>**This price includes all labor ,materials, machinery, taxes, and mobilizations required to perform the additional irrigation work required due to site additions, site changes, or scope changes. This price also includes all necessary investigative labor as needed to determine the additional work required**</i></p>	
<p>"Upon default in payment of this contract, or any part when due, the undersigned agrees to pay a reasonable attorney's fee of thirty-three and one-third (33-1/3 %) percent of the balance due and owing in the event that it is necessary that this contract be referred to an attorney for collection."</p> <p>" The undersigned further agrees to pay a one and one-half (1-1/2 %) percent per month carrying charge on the unpaid balance."</p>		SUBTOTAL
		\$ 28,465.00
		SALES TAX
		TOTAL
		\$ 28,465.00

Taylor Wilson

Acceptance of proposal





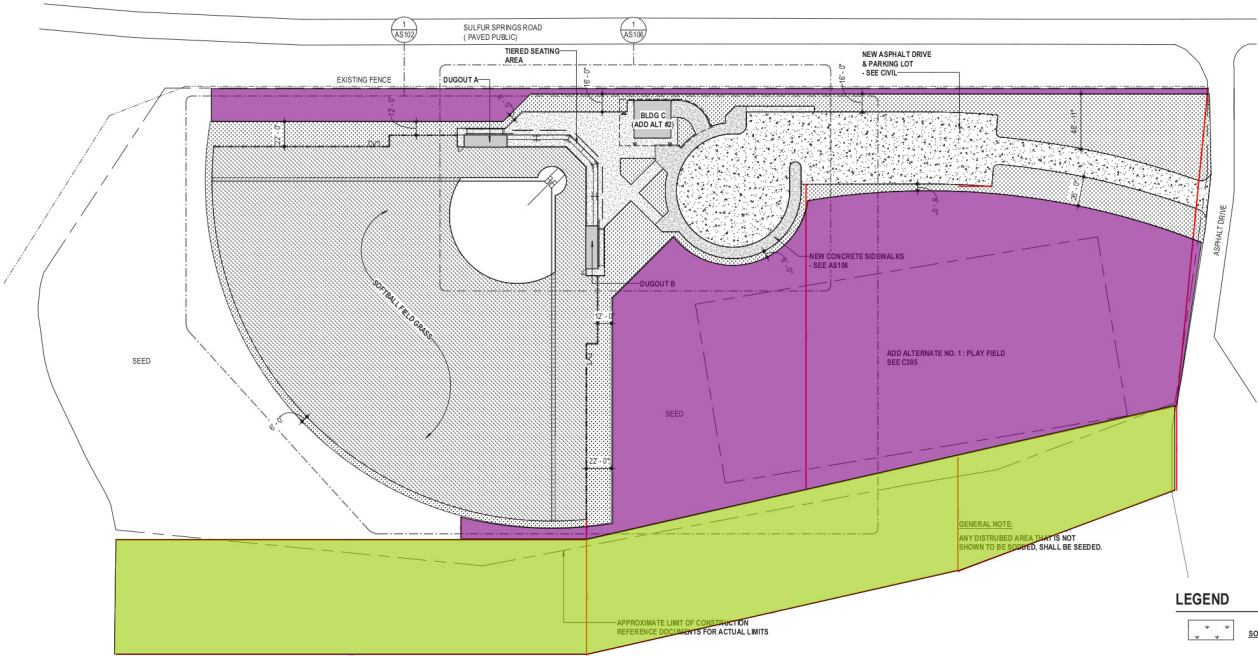

Date

PCR 14 extra sod plan: Purple = play field; Green = slope area (08.06.2025)



 PROJECT NORTH
 NORTH
 NORTH
SITE PLAN
A201 1" = 40'-0"

LEGEND

-  SOO
-  SOFTBALL FIELD GRASSING
-  CONCRETE PAVEMENT
-  ASPHALT PAVEMENT
-  HEAVY DUTY CONCRETE PAVEMENT
-  WORK ASSOCIATED W/ ALT #0
-  FENCING

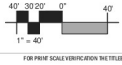

Revisions:	Project	Lead:	Project:	Date:	Drawn:	Checked:
1.	JMI		510278	31.14.2024	JMI	JMI
2.						
3.						

SOFTBALL COMPLEX SULFUR SPRINGS PARK
MADISON COUNTY BOARD OF SUPERVISORS
929 SULFUR SPRINGS ROAD CAMDEN, MS 39045



SITE PLAN

AS101

England Enterprises, Inc.

Estimate

8295 Wildwood Road
Vaughan, MS 39179-9566
662-673-1644, fax 1646
englandenterprisesinc@gmail.com

Date	Estimate #
8/6/2025	PCR 14

Name / Address

Madison County
Drew Ridinger
Sulfur Springs Softball Field
J H & H

		Project
Description		Total
Playfield Sod and Irrigation		
Supervision /WK	750.00T	
Field Superintendent	2,800.00T	
Truck Allowance /MO	425.00T	
Insurance/MO (\$3800 full mo 2022)	1,400.00T	
Job Specific Insurance	200.00T	
Bonds	850.00T	
Gas & Oil / MO	550.00T	
Clean Up	200.00T	
Telephone/MO	75.00T	
Equipment/MO	1,000.00T	
Sod	55,760.00T	
Landscape Irrigation	13,565.00T	
Seeding Deduct Less Restocking fee of \$6120	-9,280.00T	
Subtotal	68,295.00	
Overhead and Profit	6,829.50T	
Subtotal	75,124.50	
MPC Tax	2,727.02	
Subtotal	77,851.52	
Slope Sod and Irrigation		
Supervision	750.00T	
Field Superintendent	2,800.00T	
Truck Allowance /MO	425.00T	
Insurance/MO (\$3800 full mo 2022)	1,400.00T	
Job Specific Insurance	200.00T	
Bonds	850.00T	
Subtotal		
Sales Tax (0.0%)		
Total		

England Enterprises, Inc.

8295 Wildwood Road
Vaughan, MS 39179-9566
662-673-1644, fax 1646
englandenterprisesinc@gmail.com

Estimate

Date	Estimate #
8/6/2025	PCR 14

Name / Address
Madison County Drew Ridinger Sulfur Springs Softball Field J H & H

[illegible]